

TOMADAS PARA APARELHOS

ESPECIFICAÇÕES:

CARACTERÍSTICAS ELÉTRICAS: 10A ou 20A em tensões de até 250V~.

Modelos com poço externo ou interno atendem ao padrão brasileiro de plugues e tomadas (NBR 14136).

Produtos certificados pelo Bureau Veritas (BV).

interruptores para aparelhos



Referência	N° de Condutores	Poço
TPA1 - 3	3 (2P+T)	Externo
TPA2 - 3	3 (2P+T)	Interno

POÇO EXTERNO



POÇO INTERNO



DIMENSÕES

POÇO EXTERNO

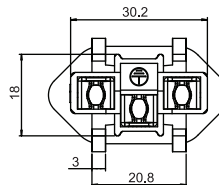
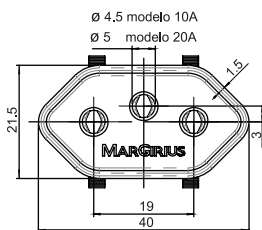
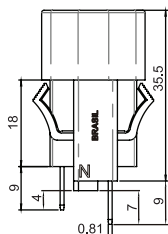
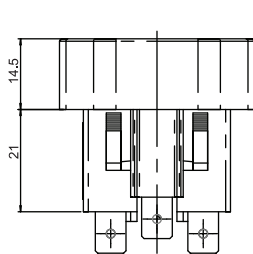

Rasgo para encaixe

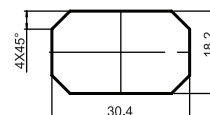

Espessura do painel:
0,8 a 2mm
2 a 4mm*
*sob consulta

POÇO INTERNO

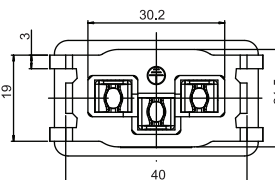
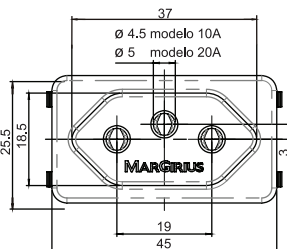
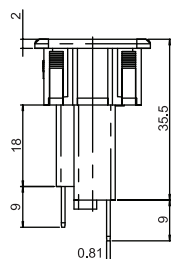
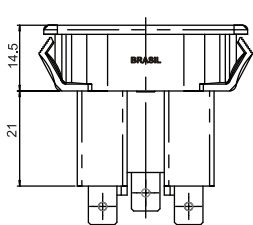

Rasgo para encaixe

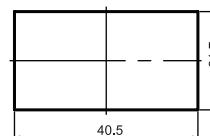

Espessura do painel:
0,8 a 2mm
2 a 4mm*
*sob consulta

TERMINAIS

E2* - Faston
4,8 x 0,8mm

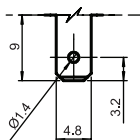

E3 - Faston
6,3 x 0,8mm

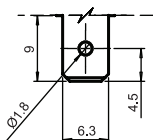

E4 - Faston c/rasgo
6,3 x 0,8mm

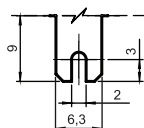

E5 - Solda
2,8 x 0,8mm

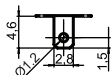

E6 - Solda
6,3 x 0,8mm

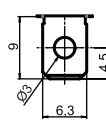

CI - Terminal
PC

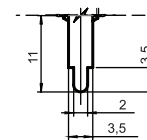

*Terminal E2 somente para tomadas de 10A.

- CORES

A - azul
AC - creme
B - branco
C - amarelo
D - verde
E - vermelho
F - preto - (standard)
G - cinza
H - marrom

CONTATOS

10A
20A

BARRA DE CODIFICAÇÃO

TPA □□□□ - □ □ □
Referência Terminal Cor Contatos
TPA1 - 3 E2 10A
TPA2 - 3 E3 20A
E4
E5
E6
CI
Cabo

Cabo - Rabicho 150mm*
3 x 1,5mm²

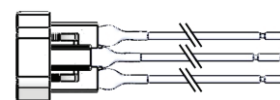

*Outros comprimentos e bitolas sob consulta